

WithWave's terminations are composed of broadband, due to the coaxial construction, it offers a excellent performance specified from DC to 6 GHz Precision SMA coaxial connector interfaces ensure an good impedance match across wide bandwidth.



■ Features

- DC to 6 GHz
- VSWR : 1.10 : 1 (Max.)
- Power rating : 2 W @ 25~70 °C
- Temperature range : -55 ~ 100 °C

■ Specification

| Scope | Specification | TM06-02-01A |
|------------|-------------------|------------------------|
| Electrical | Impedance(Ohm) | 50 |
| | Freq. range (GHz) | DC to 6 |
| | VSWR | 1.10 : 1 (Max) |
| | Power rating | 2 W @ 25~70 °C |
| | Dielectric | PTFE |
| Material | Center Contact | Brass with gold plated |
| | Body & Connector | Brass with gold plated |

■ Drawing

Part No. : TM06-02-02A

Unit : mm

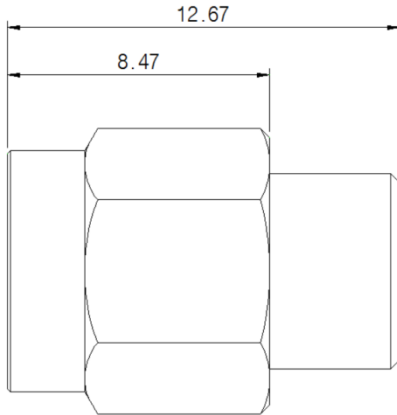

■ Measurement result



- Freq. range : 10 MHz to 6 GHz