

WithWave's DC Blocks are composed of broadband, coaxial blocking capacitors. Due to the coaxial construction, It offers a excellent RF performance specified from 30 MHz to 26.5 GHz. Precision SMA coaxial connector interfaces ensure an excellent impedance match across wide bandwidth.

■ Features

- Frequency : 30 MHz to 26.5 GHz
- SMA type (Male to Female)
- VSWR(Max): 1.25 : 1
- Insertion Loss (Max) : 0.35 dB @ 26.5 GHz



■ Specification

| Scope | Specification | DC06-01 |
|------------|---------------------------|-----------------------------------|
| Electrical | Impedance(Ohm) | 50 |
| | Operation Freq.(GHz) | 0.030~26.5 |
| | Insertion Loss (dB) : Max | 0.35 |
| | Working Voltage(V) | 50 |
| | VSWR (Max) | 1.25 : 1 |
| Material | Dielectric | PTFE |
| | Center Contact | Beryllium copper with gold plated |
| | Body | Stainless Steel |

* RoHS Compliant

■ Drawing

Unit : mm[inch]

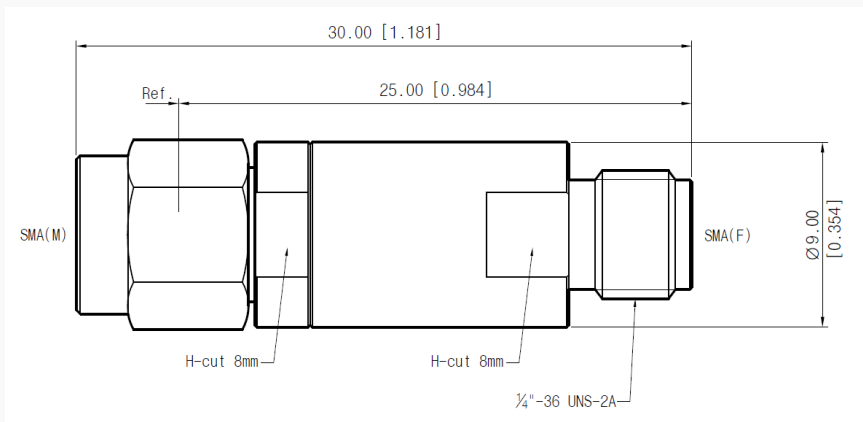

■ Test Result

Freq: 30 MHz to 26.5 GHz

