

<Specification>

1. Electrical
  - 1-1. impedance : 50Ω
  - 1-2. Frequency range : DC to 67GHz
  - 1-3. VSWR(dB) : 1.3 : 1(-17.69dB)
  - 1-4. Insertion Loss : 0.4dB max.
2. Material
  - 2-1. Body : Stainless Steel(STS303)
  - 2-2. Pin : BeCu(C1720)
  - 2-3. Insulator : Ultem1000
  - 2-4. Hex Nut : Stainless Steel(STS303)
  - 2-5. Lock Washer : Stainless Steel(STS304)
3. Mechanical
  - 3-1. Durability : 500 CyclesW
4. Environmental
  - 1) Temp. Range : -40°C to +125°C
  - 2) RoHS Compliant

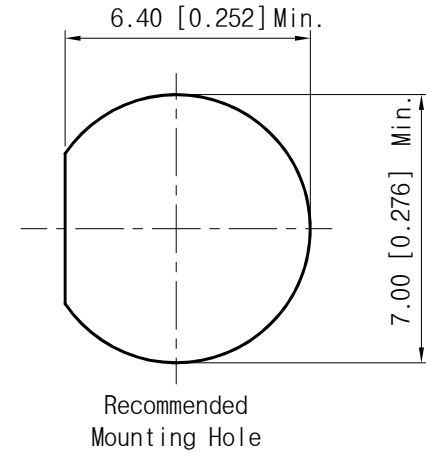
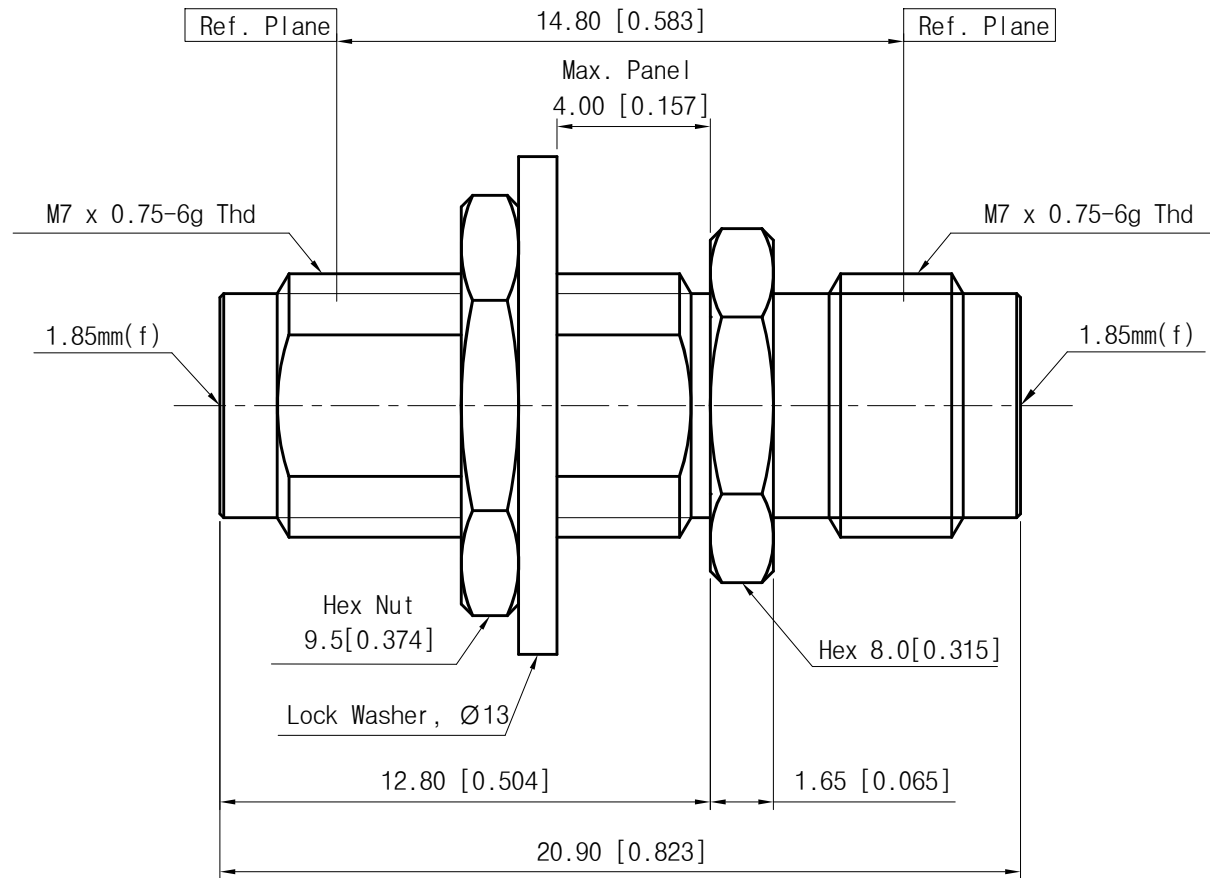

|          |  |
|----------|--|
| Title    | 1.85mm(F) to 1.85mm(F) Bulkhead Type Adapter |
| Part No. | AD01F01FS2                                   |

THE INFORMATION HEREON/HEREIN IS PROPRIETARY TO WITH-WAVE CO., LTD. IT SHALL NOT BE COUPIED, DISCLOSED OR USED(PARTIALLY OR WHOLLY) IN ANY MANNER WITHOUT PRIOR EXPRESSED WRITTEN AUTHORIZATION OF WITH-WAVE CO., LTD.

|       |          |       |              |
|-------|----------|-------|--------------|
| Scale | N/A      | Date  | 2019. 04. 09 |
| Unit  | mm[inch] | Drawn | Ter i K      |

**withwave**

Rev. -